

QUICK START GUIDE

TUNE125TWS



WHAT'S IN THE BOX



HOW TO WEAR

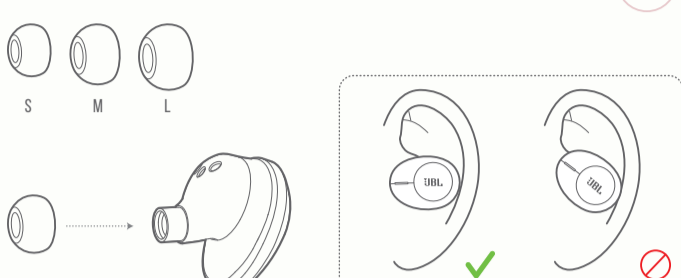

FIRST TIME USE

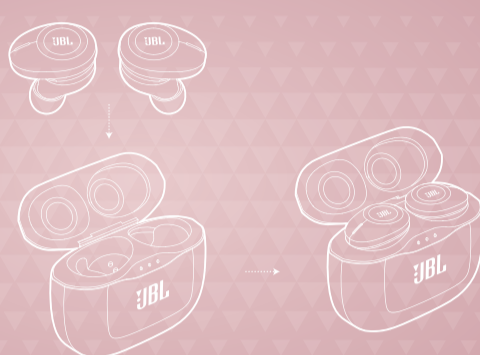

POWER ON & CONNECT

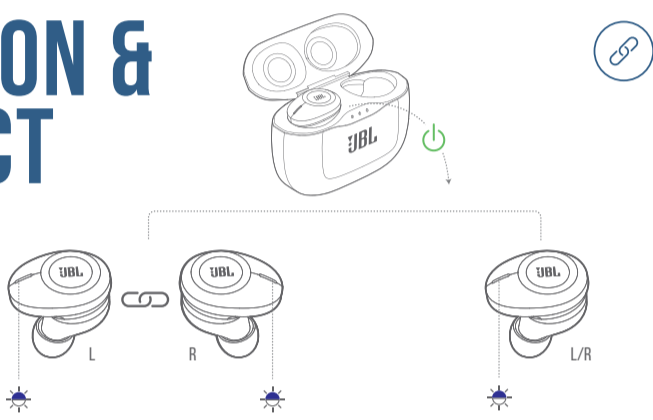

PAIRING



POWER OFF

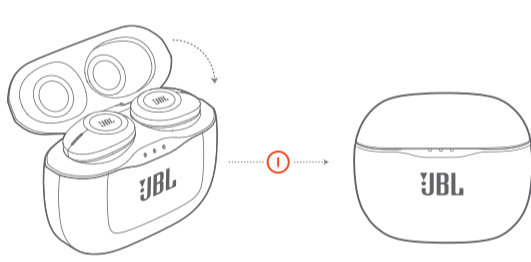

MANUAL CONTROLS

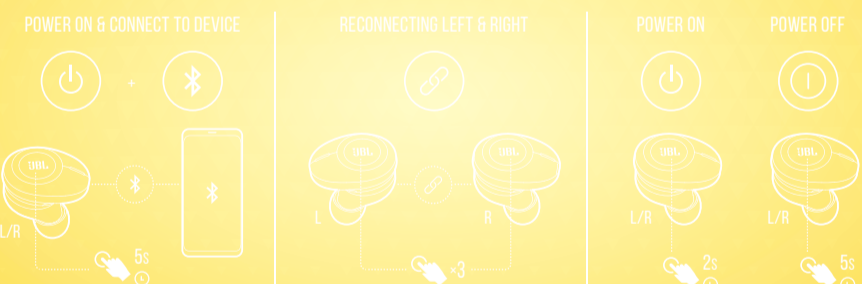

BUTTON COMMAND

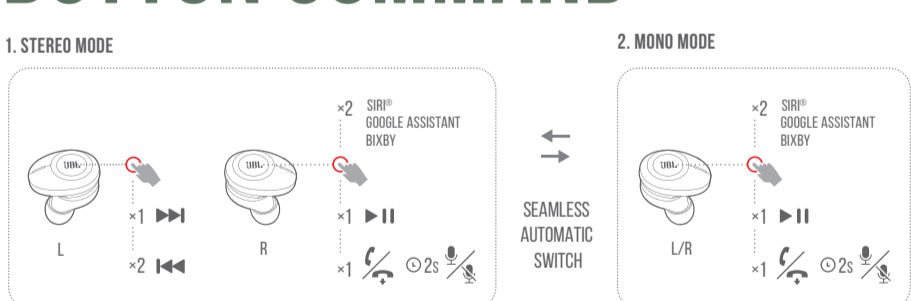

CHARGING

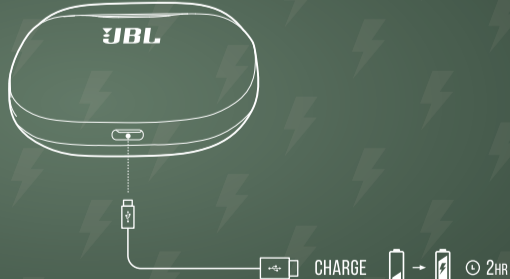

LED BEHAVIORS

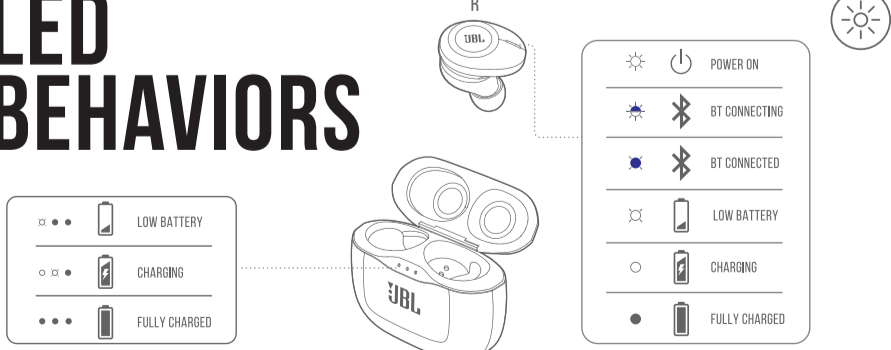

TECH SPEC

| | |
|--|--|
| Driver size: | 5.8 mm Dynamic driver |
| Frequency response: | 20 Hz – 20 kHz |
| Sensitivity: | 96 dB SPL @ 1 kHz 1 mW |
| Maximum SPL: | 96 dB |
| Microphone sensitivity: | -38 dBV / Pa @ 1 kHz |
| Impedance: | 14 ohm |
| Bluetooth transmitted power: | < 12 dBm |
| Bluetooth modulation: | GFSK, π/4 DQPSK, 8DPSK |
| Bluetooth frequency: | 2.402 GHz - 2.480 GHz |
| Bluetooth profile version: | A2DP 1.3, AVRCP 1.5, HFP V1.7 |
| Bluetooth version: | 5.0 |
| Headset battery type: | Lithium-ion battery (85 mAh / 3.7 V DC) |
| Charging case battery type: | Lithium-ion battery (850 mAh / 3.7 V DC) |
| Power supply: | 5 V ~ 1.0 A |
| Charging time (headset & charging case): | < 2 hrs from empty |
| Music playtime with BT on: | 8 hrs |
| Weight: | 73 g |

